

Copied from *Richard's* Plotter
 - Wm. E. Saunders Jr. Dated July 6-1871
 - 582 - West at N. 1/4 cor. of N. E. 1/4 Sec 6
 T-6-N-R-1-W. E. 51. Rods = 12.75 ch = 841 ft
 thence S. 63 Rods = 15.75 ch = 1039.5 ft
 W. 51. Rods = 12.75 ch = 841.5 ft thence
 North 63 Rods = 1039.5 ft to begin 20.08 ac.

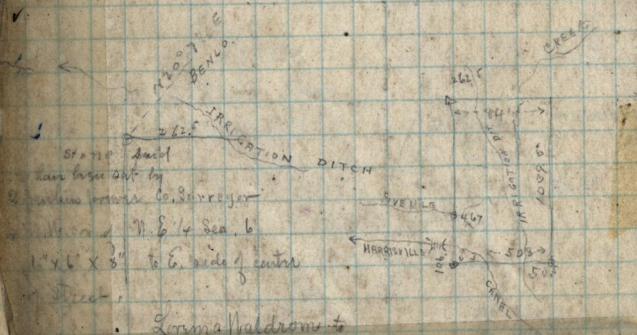

Louisa Waldron to
 Mariah Saunders